

flypod®

Decorative Glueboard Insect Control

Please read these instructions carefully and store in a safe place for future reference.

FLYPOD®

As part of the **Insect-O-Cutor®** brand of insect control products, **Flypod®** is an easy to service and highly effective decorative insect control unit for use within front of house applications. **Flypod®** utilises a highly effective UV tube and is designed for use with a high specification **glupac®** glueboard. Patented glueboard technology ensures the user doesn't come into contact with caught flies.

CONTENTS OF PACKAGE

- 1 x Flypod® flykiller
- 1 x **glupac®** pheromone impregnated glueboard
- 1 x Compact 18W tube (fitted)

WARNING - THIS APPLIANCE MUST BE EARTHED (CLASS 1)

INSECT CONTROL PRODUCTS

Flypod® utilises high powered ultra violet tubes to attract flying insects and retains the caught insects on a pheromone impregnated glueboard for inspection or hygienic disposal.

WARNING

Flypod® is not to be used by children or persons with reduced physical, sensory or mental capabilities, or lack of experience and knowledge, unless they have been given supervision or instruction.

Children should be supervised to ensure they do not play with the appliance.

If the mains cable is damaged it must be replaced by a specialist mains cable available from P+L Systems Ltd or your supplier.

Not suitable for applications where potentially explosive environments may exist.

POSITIONING AND GUIDANCE FOR USE

THIS UNIT IS FOR INDOOR USE ONLY.

Flypod® should ideally be positioned in the darkest place within the area to be protected. Do not position the unit close to windows, skylights or other sources of light, or where it may be obscured by furniture, doors or other obstacles. Ideally, **Flypod®** should be visible from every part of the area to be protected.

Flypod® should ideally be in operation for 24 hours a day, ensuring your premises are kept free of flying insects. Insects are most attracted to **Flypod®** at night when there is no competition from daylight or other light sources.

GUARANTEE

Flypod® has a two year guarantee and if maintained as recommended in these instructions should continue to work for many years.* Use of non-approved consumables may invalidate the guarantee. Ensure genuine **glupac®** glueboards are used in conjunction with this product.

*Excludes tube, glueboard and starter. Does not cover breakdown due to misuse, incorrect operation or use in an incorrect application.

INSTALLATION

INSTALLATION SHOULD BE CARRIED OUT BY SERVICE PERSONNEL ONLY.

Flypod® Once correctly positioned on a horizontal surface, fit the **glupac®** glueboard in position as described in the glueboard replacement section of this document. **Flypod®** has a plug fitted to the mains lead and once installed in position, should be plugged into the nearest mains outlet.

CLEANING

CLEANING SHOULD BE CARRIED OUT BY SERVICE PERSONNEL ONLY, AFTER ENSURING THAT THE UNIT IS DISCONNECTED FROM THE MAINS SUPPLY.

It is recommended that cleaning is carried out regularly when the glueboard is replaced. Once the glueboard is removed, the unit should be thoroughly wiped down with a damp cloth, removing any build up of dirt. Ensure the unit is completely dry before reconnecting it to the power supply.

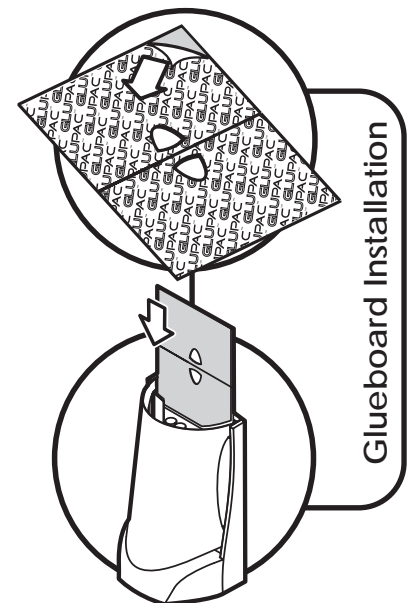

GLUEBOARD REPLACEMENT

GLUEBOARD REPLACEMENT SHOULD BE CARRIED OUT BY SERVICE PERSONNEL ONLY, AFTER ENSURING THAT THE UNIT IS DISCONNECTED FROM THE MAINS SUPPLY.

The glueboard should be replaced every month with a genuine glupac® glueboard. Use of non-approved glueboards may invalidate your guarantee.

To replace the glueboard...

1. Position **Flypod** so the back is facing you.
2. Using one hand to support the unit, use your thumb and forefinger of your other hand to gently pull the used glueboard out through the slot in the back of the unit.
3. Once free from the unit, dispose of the used glueboard hygienically.
4. Remove the protective release paper from the new glupac® glueboard.
5. Slowly slide the new glueboard into position along the two runners with the adhesive side facing the tube.

Always ensure the selected genuine glupac® glueboards are compatible with your unit, available from your pest control operator or P+L Systems Ltd.

TUBE REPLACEMENT

TUBE REPLACEMENT SHOULD BE CARRIED OUT BY SERVICE PERSONNEL ONLY, AFTER ENSURING THAT THE UNIT IS DISCONNECTED FROM THE MAINS SUPPLY.

To ensure the efficiency of **Flypod** in catching flying insects, the UV tube should be replaced annually. After twelve months the phosphor coating that emits the correct wavelength of UV light has burnt away and the UV output is diminished substantially.

To replace the UV tube...

1. Pull the tube gently from the tube holder until it un-clips.
2. Dispose of the used UV tube in conjunction with local WEEE regulations.

STARTER REPLACEMENT

STARTER REPLACEMENT SHOULD BE CARRIED OUT BY SERVICE PERSONNEL ONLY, AFTER ENSURING THAT THE UNIT IS DISCONNECTED FROM THE MAINS SUPPLY.

The starter provides an extra spark to initially light the UV tube. Starters wear out and should be replaced at the same intervals as the UV tube.

To replace the starter...

1. Remove the glueboard from the units described above.
2. Rotate the starter anti-clockwise.
3. Pull the starter free from the unit.

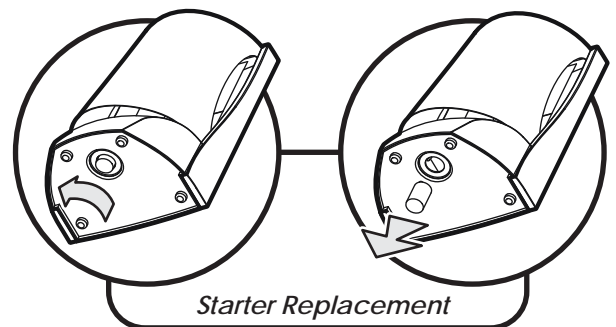
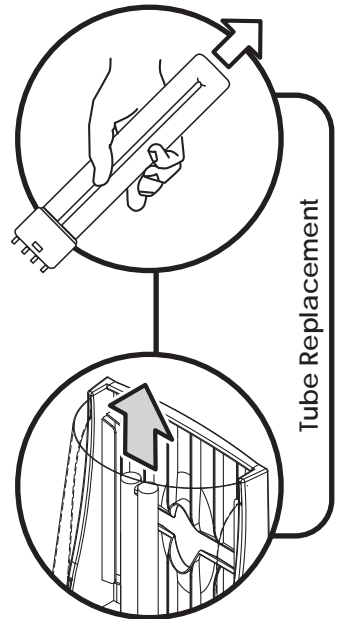
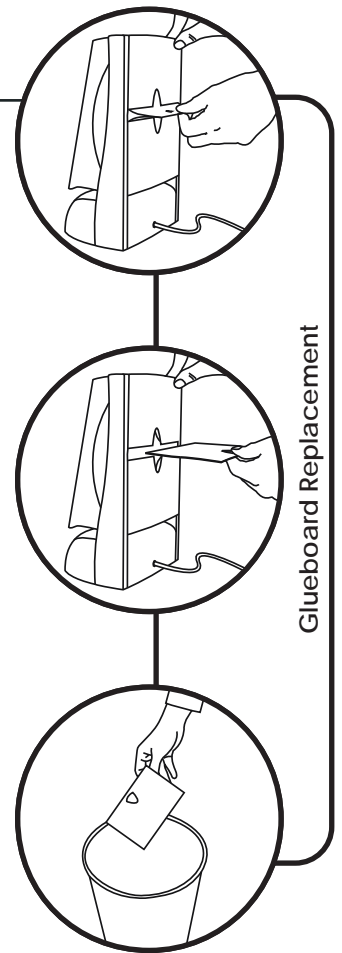

SPECIFICATION / REPLACEMENT PARTS

Unit	Flypod
Voltage	230V - 50Hz
Dimensions (mm)	200 x 310 x 170
Coverage	30 Sq. Meters
Weight	1.5kg
Light Output	18W
Tubes	1 x TPX18
Starter	1 x I154
Glueboard (x6)	INF252 (White)